

MINI GREEN LASER SIGHT

WITH WEAVER STYLE

MOUNT AND BASE

ITEM: HG15

INSTRUCTIONS

MINI GREEN LASER WITH WEAVER STYLE

MOUNT AND BASE

This Green Laser is designed to mount directly to your compact pistol or firearm. The laser sight will not replace other sighting devices related with accuracy, but it will certainly aid in locating your target with ease. This Green Laser can be mounted easily on almost any Picatinny or Weaver style base in any configuration that you choose.

NOTE: PLEASE FOLLOW ALL OF THE DIRECTIONS IN THIS MANUAL CAREFULLY.

DANGER: AVOID DIRECT EYE EXPOSURE TO LASER BEAM. LASER RADIATION IS EMITTED FROM THE APERTURE.

If you are not sure about any of the procedures in this manual, please always seek the help of a qualified professional to avoid the damage of your Green Laser and your firearm.

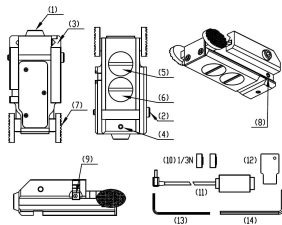

Figure 1

Statement:

This product has been carefully checked and tested in our factory, please check carefully whether the product appearance is damaged caused by transport and whether the accessories are complete before using the product. The accessories include: 1. laser sight; 2. 1.5mm Allen wrench; 3. 2.5mm Allen wrench; 4. a remote wire pressure switch; 5. Instruction manual ; 6. 2pcs CR 1/3N batteries or 4pcs AG13 batteries.

Note: Always be sure to turn off this laser sight after use to avoid draining the battery. When you don't use it for a long time, remove the battery.

Warning:

DANGER: AVOID DIRECT EYE EXPOSURE TO LASER BEAM.

LASER RADIATION IS EMITTED FROM THE APERTURE.

FOR ADULT USE ONLY.

Maintenance:

If this product is used in an environment with more dust, vapor and smoke, which leads to the lowering of beam quality, it is recommended to gently wipe the lens of optical port by using a clean and soft cloth or lens cleaning paper in a timely manner. Unless a professional, no wiping with any solvents is allowed, so as to avoid product light quality degradation caused by the lowering of lens quality.

Specifications:

- Model: HG15
- Laser Maximum output power: <5mW
- Laser Wavelength: 510-535nm (lime green)
- Class 3a laser product
- Voltage: 6.0V
- Requires 2pcs of CR 1/3N batteries (included) or 4pcs of AG13 batteries
- Runtime: About 1.5hours(CR 1/3N batteries)
- Working Temperature:-20℃ ~ +50℃
- Storage Temperature:-20℃ ~ +60℃
- Body Material: Aluminium Alloy
- Body Color: Black
- Two Modes:
 - (1)Only standard momentary ON/OFF switch:
 - Laser on(switch pad on the right);
 - Laser off(switch pad on the left).
 - (2)One remote wire pressure switch:
 - The laser is always on when you depress the remote wire press switch pad when the momentary ON/OFF switch pad is on the left.
 - The remote wire press switch will not work when the momentary ON/OFF switch pad is on the right.
- Weight (net): 44g (1.57 ounce,batteries incl.)
- Length: 2.5 inch
- Height: 20mm (0.8 inch)
- Place of Origin: China (Mainland)

Installing the battery:

CAUTION: BEFORE INSTALLATION OF YOUR GREEN LASER, BE SURE THAT THE FIREARM IS UNLOADED. ALWAYS PRACTICE SAFE FIREARMS HANDLING PROCEDURES.

Before you mount and use your Green laser, you must first insert 2pcs CR 1/3N batteries(10) or 4pcs AG13 batteries. This is a very simple procedure that takes only a few moments. Begin by grasping the unit of the Main Body with the battery cap facing up. Turn up the Battery Cap(5)&(6) counterclockwise by provided tool(12) until the Battery Cap(5)&(6) is free from the Main Body. Place 2pcs AG13 batteries or 1pc CR 1/3N battery(10) into the Battery Housing with the cap(6),negative end “-” first . The positive end “+” of the battery should now be facing out of the Battery Housing and towards to the Battery Cap(6).And place another 2pcs AG13 batteries or 1pc CR 1/3N battery(10) into the Battery Housing with the cap(5),positive end “+” first . The negative end “-” of the battery should now be facing out of the Battery Housing and towards to the Battery Cap(5). Finish the battery installation by reloading the Battery Cap firmly snug and twisting it clockwise. When replacing the battery, only use type AG13 batteries or CR 1/3N batteries. Please load the battery correctly for your product and make sure the battery is not installed backwards, otherwise it could damage your product.

Mounting:

CAUTION: BEFORE INSTALLATION OF YOUR GREEN LASER, BE SURE THAT THE FIREARM IS UNLOADED. ALWAYS PRACTICE SAFE FIREARMS HANDLING PROCEDURES.

Your new Green Laser is designed to mount directly to just about any Weaver style or Picatinny rail. To install, firstly insert the mounting bolt(2) by using the provided Allen wrench (14) so that the fixture block is in a suitable location; Once you have the mount in the desired position, tighten the outside Allen head bolt clockwise and be sure it is mounted to your rail. Be careful not to over tighten the mounting bolt(2) to avoid stripping them. Also, be sure that the mounting location for the laser allows for proper function.

Dismounting:

To dismount your Laser sight: Grasp the Main Body and loosen the mounting bolt (2) by using the provided Allen wrench (14). You can then remove the laser from the rail. Your Laser is now dismounted.

Zeroing:

WHEN OPERATING ANY TYPE OF FIREARM,PLS ALWAYS USE PROPER EYE AND EAR PROTECTION. BE SURE TO USE YOUR FIREARM IN AN AREA THAT IS PERMISSABLE UNDER LOCAL, STATE AND FEDERAL LAW.

Set up a target at the desired distance. In the beginning of the zeroing, turn your laser to ON position by pressing switch(7).

Place your laser beam on the center of the target. Be sure to fix the firearm so that it will not move when firing. Fire a few shots to see where the projectiles impact on your target in relation to the laser beam. Adjust the laser's windage and elevation in order to match the shot grouping by using the provided Allen wrench(13) to adjust the head set screws (8) and (4). After adjusting the laser beam to be matched to the location of the shot grouping, fire a few more shots to confirm zero. If the laser is still not zeroed then follow the same procedure again and make small adjustments until the desired level of accuracy is achieved. Using a laser bore sighter will also make the zeroing process a little easier. Another method is by using the iron sights of the firearm if they are available.

Note: Laser Windage and Elevation Adjustments:

To adjust the Windage of the Laser, insert the provided Allen wrench (13) into the head of the Windage Adjuster Set Screw (8) located in the side of the laser body. Turn the Windage Adjuster Clockwise to adjust the Laser Dot to the Left. Turn the Windage Adjuster Counterclockwise to adjust the Laser Dot to the Right. To adjust the Elevation of the Laser, insert the provided Allen wrench (13) into the head Elevation Adjuster Set Screw (4) located in the top of the laser body. Turn the Elevation Adjuster Clockwise to adjust the Laser Dot Up. Turn the Elevation Adjuster Counterclockwise to adjust the Laser Dot Down.

SPECIAL NOTE: THIS UNIT WILL ONLY WORK UNDER THE TEMPERATURES LISTED ABOVE. THE UNIT WILL NOT WORK IN EXTREME COLD OR EXTREME HEAT. ONCE THE UNIT IS RETURNED TO NORMAL TEMPERATURES IT WILL WORK PROPERLY.

Use switches:

1. Use the standard ON/OFF switch(7)
 - To normally use the standard ON/OFF switch(7), pls pull off the plug of the remote wire pressure switch from jack(9) of the body.
 - a) Laser is on if the switch pad is on the right.
 - b) Laser is off if the switch pad is on the left.
2. Use remote wire pressure switch(11)

To normally use the wire pressure switch: At first,make sure the laser sight is OFF;Second,insert the plug of the remote wire pressure switch into jack of the body (9). Otherwise, the remote wire pressure switch will not work.

The laser is turned on by depressing the remote wire pressure switch pad (11) and the laser is turned off by relaxing the remote wire pressure switch pad (11).

CAUTION - LASER LIGHT IS BRIGHT AND BLINDING - DO NOT SHINE AT AIRCRAFT OR VEHICLES AT ANY DISTANCE.